

固定刀座 DIN69880

STATIC TOOL HOLDER DIN69880

C1 右手系,
车刀刃向上

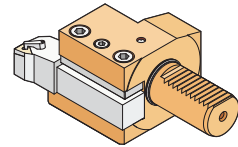
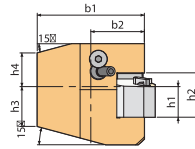
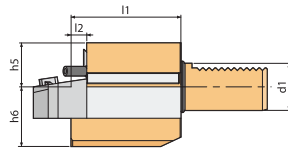

DIMENSIONS

Order NO.	d1	b1	b2	b3	h1	h2	h3	h4	h5	h6	l1	l2	l3	N.W.Kg
C1-30×20	30	70	35	17	20	29	26	22	28	38	70	10	30	1.79
C1-40×25	40	85	42.5	20.5	25	34	35	30	32.5	48	85	12.5	30	3.12
C1-50×32	50	100	50	25.5	32	41	42	35	35	60	100	16	40	5.37

C2 左手系,
车刀刃向上

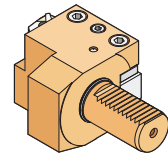
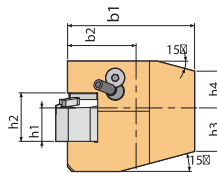
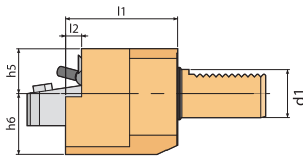

DIMENSIONS

Order NO.	d1	b1	b2	b3	h1	h2	h3	h4	h5	h6	l1	l2	l3	N.W.Kg
C2-30×20	30	76	41	23	20	29	26	22	28	38	70	10	30	1.97
C2-40×25	40	90	47.5	25.5	25	34	35	30	32.5	48	85	12.5	30	3.42
C2-50×32	50	105	55	30.5	32	41	42	35	35	60	100	16	40	5.73

C3 右手系,
车刀刃向下(反向)

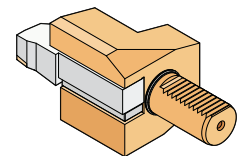
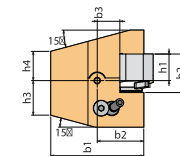
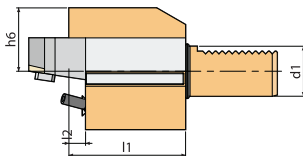

DIMENSIONS

Order NO.	d1	b1	b2	b3	h1	h2	h3	h4	h5	h6	l1	l2	l3	N.W.Kg
C3-30×20	30	70	35	17	20	29	26	22	35	38	70	10	30	2.12
C3-40×25	40	85	42.5	20.5	25	34	35	30	42.5	48	85	12.5	30	3.68
C3-50×32	50	100	50	25.5	32	41	42	35	50	60	100	16	40	6.20

C4 左手系,
车刀刃向下(反向)

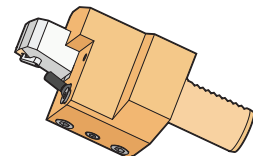
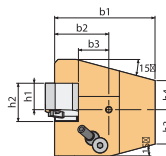
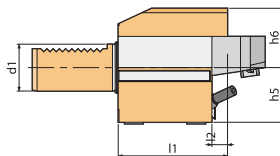

DIMENSIONS

Order NO.	d1	b1	b2	b3	h1	h2	h3	h4	h5	h6	l1	l2	N.W.Kg
C4-30×20	30	76	41	23	20	29	26	22	35	38	70	10	2.12
C4-40×25	40	90	47.5	25.5	25	34	35	30	42.5	48	85	12.5	3.68
C4-50×32	50	105	55	30.5	32	41	42	35	50	60	100	16	6.20