

# 固定刀座 DIN69880

## STATIC TOOL HOLDER DIN69880

**B5** 右手系，长，  
车刀刃向上

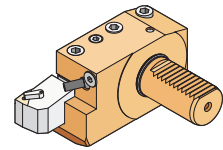
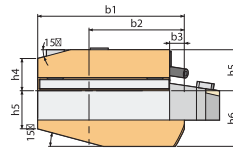
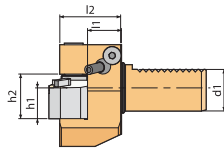

### DIMENSIONS

Order NO.	d1	b1	b2	b3	h1	h2	h3	h4	h5	h6	l1	l2	N.W.Kg
B5-30×20	30	100	65	10	20	29	26	22	28	38	22	40	1.73
B5-40×25	40	118	75.5	12.5	25	34	35	30	32.5	48	22	44	2.88
B5-50×32	50	130	80	16	32	41	42	35	35	60	30	55	5.00

**B6** 左手系，长，  
车刀刃向上

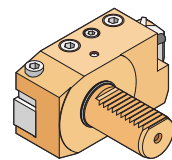
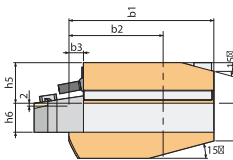
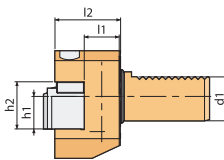

### DIMENSIONS

Order NO.	d1	b1	b2	b3	h1	h2	h3	h4	h5	h6	l1	l2	N.W.Kg
B6-30×20	30	100	65	10	20	29	26	22	28	38	22	40	1.73
B6-40×25	40	118	75.5	12.5	25	34	35	30	32.5	48	22	44	2.88
B6-50×32	50	130	80	16	32	41	42	35	35	60	30	55	5.00

**B7** 右手系，长，  
车刀刃向下(反向)

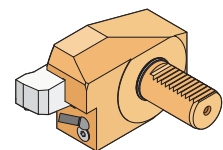
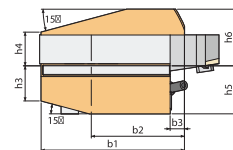
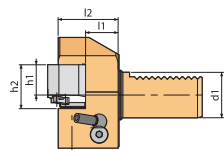

### DIMENSIONS

Order NO.	d1	b1	b2	b3	h1	h2	h3	h4	h5	h6	l1	l2	N.W.Kg
B7-30×20	30	100	65	10	20	29	26	22	35	38	22	40	1.84
B7-40×25	40	118	75.5	12.5	25	34	35	30	42.5	48	22	44	3.16
B7-50×32	50	130	80	16	32	41	42	35	50	60	30	55	5.32

**B8** 左手系，长，  
车刀刃向下(反向)

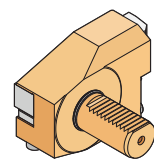
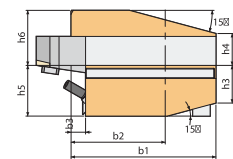
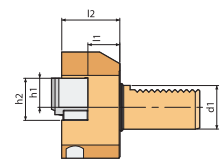

### DIMENSIONS

Order NO.	d1	b1	b2	b3	h1	h2	h3	h4	h5	h6	l1	l2	N.W.Kg
B8-30×20	30	70	35	10	20	29	26	22	28	38	22	40	1.84
B8-40×25	40	85	42.5	12.5	25	34	35	30	32.5	48	22	44	3.16
B8-50×32	50	100	50	16	32	41	42	35	35	60	30	55	5.32