

**圆柱头内沟槽带表卡尺**

Dial Caliper with Round Measuring Points for Inside Grooves

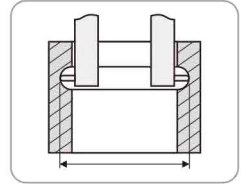

**主要特点:**

- 测头较长，便于测量孔内较深的沟槽直径
- 读数清晰、直观
- 刻度盘位置可调整，并借助锁紧螺钉紧固

**FEATURES**

- With long measuring heads, easy to measure the deep groove dimensions in a hole
- Easy to read
- The adjustable dial face can be fastened by a clamping screw

货号 Code NO.	测量范围 Measuring Range mm	分度值 Graduation mm	精度 Accuracy mm	示值/周 Range/rev.	L	a	b	c	d	e	f
175-332	20-150	0.02	±0.04	2	236	34	3	7	16	3	Ø2
175-332-0	20-150	0.02	±0.04	2	236	44	3	8.5	16	4	Ø2
175-334	20-200	0.02	±0.04	2	286	35.5	3	7	16	3	Ø3
175-334-1	25-200	0.02	±0.04	2	286	45.5	3	8.5	16	4	Ø3
175-334-2	30-200	0.02	±0.04	2	286	55.5	3	9	16	5	Ø3
175-336	30-300	0.02	±0.05	2	400	43.5	3	10	17	5	Ø3
175-336-1	30-300	0.02	±0.05	2	400	53.5	3	10	17	5	Ø3
175-336-2	40-300	0.02	±0.05	2	400	63.5	3	15	17	5	Ø3
175-336-3	40-300	0.02	±0.05	2	400	73.5	3	15	17	5	Ø3
175-336-4	50-300	0.02	±0.05	2	400	83.5	3	15	17	10	Ø3

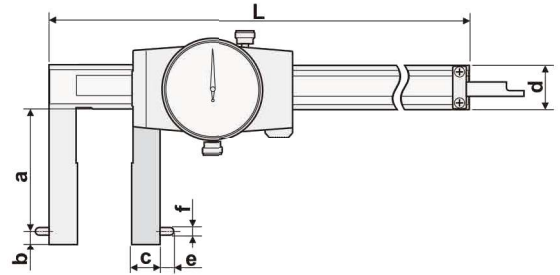

F

**圆柱头外沟槽带表卡尺**

Dial Caliper with Round Measuring Points for Outside Grooves

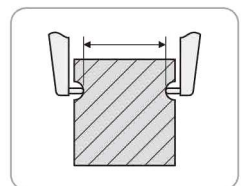

**主要特点:**

- 可测量沟槽或弯曲表面相关尺寸
- 读数清晰、直观
- 刻度盘位置可调整，并借助锁紧螺钉紧固

**FEATURES**

- For measuring groove or arch
- Easy to read
- The adjustable dial face can be fastened by a clamping screw

货号 Code NO.	测量范围 Measuring Range mm	分度值 Graduation mm	精度 Accuracy mm	示值/周 Range/rev.	L	a	b	c	d	e	f
174-332	0-150	0.02	±0.04	2	242	40	3	10	16	5	Ø2
174-334	0-200	0.02	±0.04	2	306	50	3	14	16	10	Ø2.5
174-334-1	0-200	0.02	±0.04	2	306	60	3	14	16	10	Ø2.5

