

# 固定刀座 DIN69880

## STATIC TOOL HOLDER DIN69880

**C1** 右手系,  
车刀刃向上

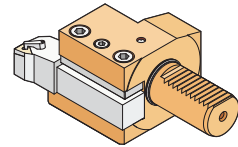
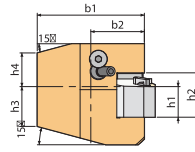
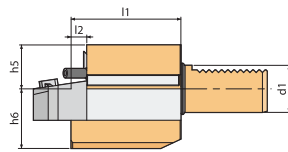

### DIMENSIONS

Order NO.	d1	b1	b2	b3	h1	h2	h3	h4	h5	h6	l1	l2	l3	N.W.Kg
C1-30×20	30	70	35	17	20	29	26	22	28	38	70	10	30	1.79
C1-40×25	40	85	42.5	20.5	25	34	35	30	32.5	48	85	12.5	30	3.12
C1-50×32	50	100	50	25.5	32	41	42	35	35	60	100	16	40	5.37

**C2** 左手系,  
车刀刃向上

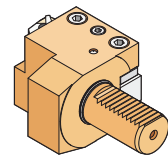
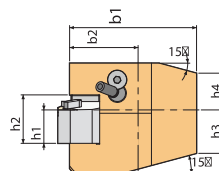
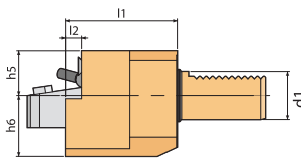

### DIMENSIONS

Order NO.	d1	b1	b2	b3	h1	h2	h3	h4	h5	h6	l1	l2	l3	N.W.Kg
C2-30×20	30	76	41	23	20	29	26	22	28	38	70	10	30	1.97
C2-40×25	40	90	47.5	25.5	25	34	35	30	32.5	48	85	12.5	30	3.42
C2-50×32	50	105	55	30.5	32	41	42	35	35	60	100	16	40	5.73

**C3** 右手系,  
车刀刃向下(反向)

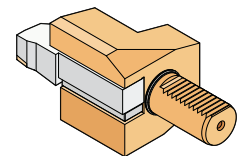
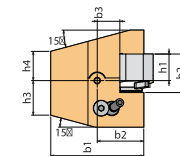
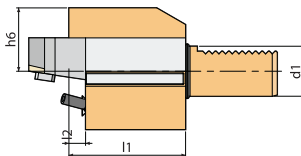

### DIMENSIONS

Order NO.	d1	b1	b2	b3	h1	h2	h3	h4	h5	h6	l1	l2	l3	N.W.Kg
C3-30×20	30	70	35	17	20	29	26	22	35	38	70	10	30	2.12
C3-40×25	40	85	42.5	20.5	25	34	35	30	42.5	48	85	12.5	30	3.68
C3-50×32	50	100	50	25.5	32	41	42	35	50	60	100	16	40	6.20

**C4** 左手系,  
车刀刃向下(反向)

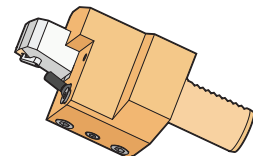
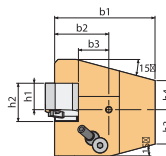
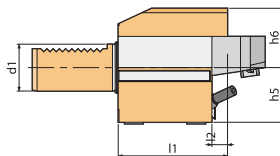

### DIMENSIONS

Order NO.	d1	b1	b2	b3	h1	h2	h3	h4	h5	h6	l1	l2	N.W.Kg
C4-30×20	30	76	41	23	20	29	26	22	35	38	70	10	2.12
C4-40×25	40	90	47.5	25.5	25	34	35	30	42.5	48	85	12.5	3.68
C4-50×32	50	105	55	30.5	32	41	42	35	50	60	100	16	6.20