

## EMR圆鼻面铣刀盘

### EMR Round dowel face mill



- 使用11° 正角刀片
- 刀片经济, 适用性高
- 容屑空间大, 排屑好
- 锥形设计, 刚性高

- ★ Using the 11° positive angle blade
- ★ Blade economy, the applicability of high
- ★ Capacity chip a large space, good chip disposal
- ★ Cone design, steel high

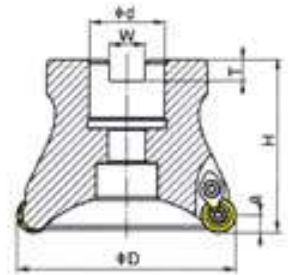

型号 Cat. No	尺寸 Size					
	D	d	H	W	T	a
EMR-5R-50-22-4T	50	22	50	10.4	6.3	5
EMR-5R-63-22-4T	63	22	50	10.4	6.3	5
EMR-5R-80-27-6T	80	27	50	12.4	7	5
EMR-5R-100-32-6T	100	32	50	14.4	7	5
EMR-5R-125-40-7T	125	40	63	16.4	9	5
EMR-5R-160-40-8T	160	40	63	16.4	9	5
EMR-5R-63-25.4-4T	63	25.4	50	10	6	5
EMR-5R-80-25.4-6T	80	25.4	50	10	6	5
EMR-5R-100-31.75-6T	100	31.75	50	13	8	5

#### 配件 Mating

型号 Cat. No	刀片 Insert	压板 Clamp piece	螺钉 Clamp screw	扳手 wrench
EMR-5R	RPMW 1003 MO RPMT 10T3 MOE	Y-5R	M4 × 10 / M3.5 × 10	T15

#### 适用刀片 Insert

型号 Cat. No	UP20M	NX2525	UT120T	F7030	VP15TF	SH8020	SH8205	JC3535	P201	刀片形状 Insert shape	尺寸 (mm) Size			
											D1	S1	排屑槽	
RPMW1003MO	●	●	●								10	3.18	无	MITSUBISHI (三菱)
RPMT10T3MOE				●	●						10	3.97	有	
RPMW1003MOEN						●	●			10	3.18	无	HITACHI (日立)	
RPMW1003MO								●	●	10	3.18	无	ROSS	

👉 圆刀片切削刃强度高  
系列产品品种丰富  
最适合模具材料加工

👉 Circular blade cutting edge strength is high.  
Series of products rich variety.  
The most suitable mold materials processing.