

BAP直角台肩面铣刀盘

BAP Right angle shoulder face mill

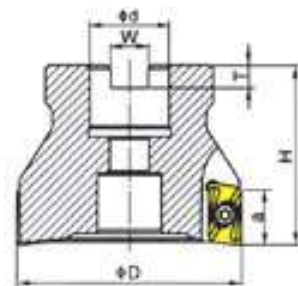

- 11° 正角刀片
 - 适配多种材质刀片, 可适用铝 钢铣削
 - 螺丝锁紧, 容屑空间大, 排屑好
 - 切削轻快, 阻力小
- ★ 11° positive angle blade
 - ★ Adaptive multi-material blade, applicable to aluminum steel milling
 - ★ Screw locking, allow a large space debris, a good chip disposal
 - ★ Cutting light, the resistance of small



| 型号 Cat. No | 尺寸 Size | | | | | |
|----------------------|---------|-------|----|------|-----|----|
| | D | d | H | W | T | a |
| BAP300R-40-16-5T | 40 | 16 | 40 | 8.4 | 5.6 | 9 |
| BAP300R-50-22-6T | 50 | 22 | 50 | 10.4 | 6.3 | 9 |
| BAP400R-50-22-4T | 50 | 22 | 50 | 10.4 | 6.3 | 14 |
| BAP400R-63-22-4T | 63 | 22 | 50 | 10.4 | 6.3 | 14 |
| BAP400R-80-27-6T | 80 | 27 | 50 | 12.4 | 7 | 14 |
| BAP400R-100-32-6T | 100 | 32 | 50 | 14.4 | 8 | 14 |
| BAP400R-125-40-7T | 125 | 40 | 63 | 16.4 | 9 | 14 |
| BAP400R-160-40-8T | 160 | 40 | 63 | 16.4 | 9 | 14 |
| BAP400R-200-60-9T | 200 | 60 | 63 | 25.7 | 14 | 14 |
| BAP400R-250-60-14T | 250 | 60 | 63 | 25.7 | 14 | 14 |
| BAP400R-63-25.4-4T | 63 | 25.4 | 50 | 10 | 6 | 14 |
| BAP400R-80-25.4-6T | 80 | 25.4 | 50 | 10 | 6 | 14 |
| BAP400R-100-31.75-6T | 100 | 31.75 | 50 | 13 | 8 | 14 |
| BAP400R-125-38.1-8T | 125 | 38.1 | 63 | 16.2 | 10 | 14 |
| BAP400R-160-50.8-9T | 160 | 50.8 | 63 | 19.3 | 11 | 14 |

配件 Mating

| 型号 Cat. No | 刀片 Insert | 螺钉 Clamp screw | 扳手 wrench |
|------------|----------------|----------------|-----------|
| BAP300R | APMT 1135 PDER | M2.5×6 | T8 |
| BAP400R | APMT 1604 PDER | M4×10 | T15 |

适用刀片 Insert

| 型号 Cat. No | F7030 | F620 | VP15TF | UP20M | NX2525 | NX4545 | UT120T | HT110 | P201 | H101 | 刀片形状 Insert shape | 尺寸 (mm) Size | | | | | |
|-----------------|-------|------|--------|-------|--------|--------|--------|-------|------|------|----------------------|--------------|-------|------|-----|-----|--------------------|
| | | | | | | | | | | | | L1 | L2 | S1 | F1 | Re | |
| APMT1604PDER-H1 | ● | | ● | | | | ● | | | | | 16.5 | 9.525 | 4.76 | 1.7 | 0.4 | MITSUBISHI (三菱) |
| 1604PDER-H2 | ● | ● | ● | ● | ● | ● | ● | | | | | 16.5 | 9.525 | 4.76 | 1.7 | 0.8 | |
| APMT1604PDER-M2 | ● | ● | ● | | | | | | | | | 16.5 | 9.525 | 4.76 | 1.7 | 0.8 | ROSS |
| APMT1604DDR | | | | | | | | | | | | 16.5 | 9.525 | 4.76 | 1.7 | 0.8 | |
| APKT160402PDSR | | | | | | | | | | | | 16.4 | 9.525 | 4.76 | - | 0.2 | |