

车削刀片(负前角型) Turning insert (negative)



SN□□

正方形有孔 Square with hole 负前角 Negative

SNMG 12 04 04- □□

90°

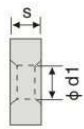
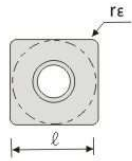

切削刃长度(ℓ) Cutting edge length 厚度(S) Thickness 刀尖圆弧半径(r_ϵ) Corner arc radius 断屑槽代号 Chip breaker code

SN□□	0903□□	1204□□	1506□□	1906□□	2507(09)□□	3109□□
φ d(mm)	3.81	5.16	6.35	7.93	9.12	8.80

刀片外形 Insert appearance	型号 Model	尺寸 Dimension					P		M		K										
		L	φ I.C	S	φ d	r	LF9008	LF9018	LF9028	LF9218	LF9118	LF918	LF6008	LF6018	LF6028	LF6118	LF618	LF3018	LF3028		
	SNMG090304-TM	9.525	9.525	3.18	3.81	0.4	○	○													
	SNMG090308-TM	9.525	9.525	3.18	3.81	0.8	○	○													
	SNMG120404-TM	12.7	12.7	4.76	5.16	0.4	▲	▲													
	SNMG120408-TM	12.7	12.7	4.76	5.16	0.8	▲	▲													
	SNMG120412-TM	12.7	12.7	4.76	5.16	1.2	▲	▲													
	SNMG120416-TM	12.7	12.7	4.76	5.16	1.6	○	○													
	SNMG150608-TM	15.9	15.9	6.35	6.35	0.8	○	○													
	SNMG150612-TM	15.9	15.9	6.35	6.35	1.2	○	○													
	SNMG190608-TM	19.1	19.1	6.35	7.94	0.8	○	○													
SNMG190612-TM	19.1	19.1	6.35	7.94	1.2	○	○														
	SNMG120404-TM	12.7	12.7	4.76	5.16	0.4			▲												
	SNMG120408-TM	12.7	12.7	4.76	5.16	0.8			▲												
	SNMG120412-TM	12.7	12.7	4.76	5.16	1.2			○												
	SNMG120404L-S	12.9	12.7	4.76	5.16	0.4			▲												
	SNMG120408L-S	12.9	12.7	4.76	5.16	0.8			▲												
	SNMG120412L-S	12.9	12.7	4.76	5.16	1.2			▲												
	SNMG120404R-S	12.7	12.7	4.76	5.16	0.4			▲												
	SNMG120408R-S	12.7	12.7	4.76	5.16	0.8			▲												
	SNMG120412R-S	12.7	12.7	4.76	5.16	1.2			▲												
	SNMG120408L-S	12.7	12.7	4.76	5.16	0.8				▲											
	SNMG120408R-S	12.7	12.7	4.76	5.16	0.8				▲											

半精切削
Semi finishing

产品库存 Product stock ▲ 主推牌号备库存 Main grade reserve stock ○ 按订单生产 Make-to-order

车削刀片(负前角型) Turning insert (negative)



SN□□

正方形有孔 Square with hole
负前角 Negative

SNMG 12 04 04- □□

90°

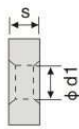
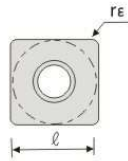

切削刃长度(ℓ) Cutting edge length 厚度(S) Thickness 刀尖圆弧半径(r_E) Corner arc radius 断屑槽代号 Chip breaker code

SN□□	0903□□	1204□□	1506□□	1906□□	2507(09)□□	3109□□
φ d(mm)	3.81	5.16	6.35	7.93	9.12	8.80

刀片外形 Insert appearance	型号 Model	尺寸 Dimension					P			M			K							
		L	φ I.C	S	φ d	r	LF9008	LF9018	LF9028	LF9218	LF9118	LF918	LF6008	LF6018	LF6028	LF6118	LF618	LF3018	LF3028	
半精加工 Semi finishing	SNMG120404-PM	12.7	12.7	4.76	5.16	0.4	▲	▲												
	SNMG120408-PM	12.7	12.7	4.76	5.16	0.8	▲	▲												
	SNMG120412-PM	12.7	12.7	4.76	5.16	1.2	▲	▲												
中等切削 Moderate	SNMG120404-PR	12.7	12.7	4.76	5.16	0.4	▲	▲												
	SNMG120408-PR	12.7	12.7	4.76	5.16	0.8	▲	▲												
	SNMG120412-PR	12.7	12.7	4.76	5.16	1.2	▲	▲												
精加工-半精加工 Finishing - Semi finishing	SNMG120404-HA	12.7	12.7	4.76	5.16	0.4						▲	▲							
	SNMG120408-HA	12.7	12.7	4.76	5.16	0.8						▲	▲							
	SNMG120412-HA	12.7	12.7	4.76	5.16	1.2						○	○							
半精加工 Semi finishing	SNMG090304-HS	9.525	9.525	3.18	3.81	0.4						○	○							
	SNMG090308-HS	9.525	9.525	3.18	3.81	0.8						○	○							
	SNMG120404-HS	12.7	12.7	4.76	5.16	0.4						▲	▲							
	SNMG120408-HS	12.7	12.7	4.76	5.16	0.8						▲	▲							
	SNMG120412-HS	12.7	12.7	4.76	5.16	1.2						○	○							
	SNMG150612-HS	15.9	15.9	6.35	6.35	1.2						○	○							
	SNMG150616-HS	15.9	15.9	6.35	6.35	1.6						○	○							
	SNMG190612-HS	19.1	19.1	6.35	7.94	1.2						○	○							
半精切削 Semi finishing	SNMG120404L-S	12.7	12.7	4.76	5.16	0.4						▲	▲							
	SNMG120408L-S	12.7	12.7	4.76	5.16	0.8						▲	▲							
	SNMG120412L-S	12.7	12.7	4.76	5.16	1.2						▲	▲							
	SNMG120404R-S	12.7	12.7	4.76	5.16	0.4						▲	▲							
	SNMG120408R-S	12.7	12.7	4.76	5.16	0.8						▲	▲							
	SNMG120412R-S	12.7	12.7	4.76	5.16	1.2						▲	▲							
	SNMG120404L-S	12.7	12.7	4.76	5.16	0.4						▲	▲							

产品库存 Product stock ▲ 主推牌号备库存 Main grade reserve stock ○ 按订单生产 Make-to-order



车削刀片(负前角型) Turning insert (negative)



SN□□

正方形有孔 Square with hole 负前角 Negative





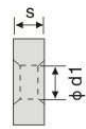
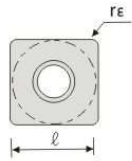



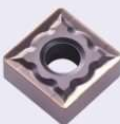

SNMG 12 04 04- □□

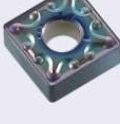
90°

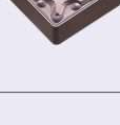

切削刃长度(ℓ) Cutting edge length 厚度(S) Thickness 刀尖圆弧半径(r_ϵ) Corner arc radius 断屑槽代号 Chip breaker code

SN□□	0903□□	1204□□	1506□□	1906□□	2507(09)□□	3109□□
φ d1(mm)	3.81	5.16	6.35	7.93	9.12	8.80

刀片外形 Insert appearance	型号 Model	尺寸 Dimension					P			M			K							
		L	φ I.C	S	φ d	r	LF9008	LF9018	LF9028	LF9218	LF9118	LF918	LF6008	LF6018	LF6028	LF6118	LF618	LF3018	LF3028	
半精加工 粗加工 Semi finishing Roughing	 SNMG120404-GS	12.7	12.7	4.76	5.16	0.4							▲	▲						
	 SNMG120408-GS	12.7	12.7	4.76	5.16	0.8							▲	▲						
	 SNMG120412-GS	12.7	12.7	4.76	5.16	1.2							▲	▲						
	 SNMG120416-GS	12.7	12.7	4.76	5.16	1.6							○	○						
	 SNMG190612-GS	19.1	19.1	6.35	7.94	1.2							○	○						
精加工 半精加工 Finishing Semi finishing	 SNMG120404-MM	12.7	12.7	4.76	5.16	0.4											▲			
	 SNMG120408-MM	12.7	12.7	4.76	5.16	0.8											▲			
	 SNMG120404-MA	12.7	12.7	4.76	5.16	0.4											▲			
	 SNMG120408-MA	12.7	12.7	4.76	5.16	0.8											▲			
中等切削 Moderate	 SNMG120404-MA	12.7	12.7	4.76	5.16	0.4							▲	▲						
	 SNMG120408-MA	12.7	12.7	4.76	5.16	0.8							▲	▲						
	 SNMG120412-MA	12.7	12.7	4.76	5.16	1.2							▲	▲						
	SNMG120416-MA	12.7	12.7	4.76	5.16	1.6							○	○						
	SNMG150608-MA	15.9	15.9	6.35	6.35	0.8							○	○						
	SNMG150612-MA	15.9	15.9	6.35	6.35	1.2							○	○						
	SNMG150616-MA	15.9	15.9	6.35	6.35	1.6							○	○						
	SNMG190612-MA	19.1	19.1	6.35	7.94	1.2							○	○						
	SNMG190616-MA	19.1	19.1	6.35	7.94	1.6							○	○						
	SNMG120404-MS	12.7	12.7	4.76	5.16	0.4												▲		
SNMG120408-MS	12.7	12.7	4.76	5.16	0.8												▲			

产品库存 Product stock ▲ 主推牌号库存 Main grade reserve stock ○ 按订单生产 Make-to-order

车削刀片(负前角型) Turning insert (negative)



SN□□

正方形有孔 Square with hole
负前角 Negative

SNMG 12 04 04- □□

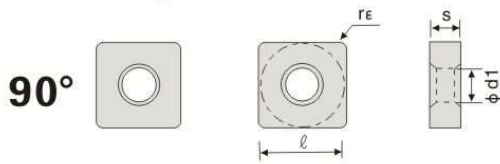

切削刃长度(ℓ) Cutting edge length 厚度(S) Thickness 刀尖圆弧半径(r_ϵ) Corner arc radius 断屑槽代号 Chip breaker code

SN□□	0903□□	1204□□	1506□□	1906□□	2507(09)□□	3109□□
φ d1(mm)	3.81	5.16	6.35	7.93	9.12	8.80

刀片外形 Insert appearance	型号 Model	尺寸 Dimension					P			M			K							
		L	φ I.C	S	φ d	r	LF9008	LF9018	LF9028	LF9218	LF9118	LF918	LF6008	LF6018	LF6028	LF6118	LF618	LF3018	LF3028	
	SNMG120404-MS	12.7	12.7	4.76	5.16	0.4							▲	▲						
	SNMG120408-MS	12.7	12.7	4.76	5.16	0.8							▲	▲						
	SNMG120412-MS	12.7	12.7	4.76	5.16	1.2							▲	▲						
	SNMG120416-MS	12.7	12.7	4.76	5.16	1.6							○	○						
	SNMG090304-MS	9.525	9.525	3.18	3.81	0.4							○	○						
	SNMG090308-MS	9.525	9.525	3.18	3.81	0.8							○	○						
	SNMG120404-MS	12.7	12.7	4.76	5.16	0.4							▲	▲						
	SNMG120408-MS	12.7	12.7	4.76	5.16	0.8							▲	▲						
	SNMG120412-MS	12.7	12.7	4.76	5.16	1.2							▲	▲						
	SNMG120416-MS	12.7	12.7	4.76	5.16	1.6							○	○						
	SNMG150612-MS	15.9	15.9	6.35	6.35	1.2							○	○						
	SNMG150616-MS	15.9	15.9	6.35	6.35	1.6							○	○						
SNMG190616-MS	19.1	19.1	6.35	7.94	1.6							○	○							
	SNMG120404-MS	12.7	12.7	4.76	5.16	0.4														▲
	SNMG120408-MS	12.7	12.7	4.76	5.16	0.8														▲
	SNMG120412-MS	12.7	12.7	4.76	5.16	1.2														▲
	SNMG120404	12.7	12.7	4.76	5.16	0.4														▲
	SNMG120408	12.7	12.7	4.76	5.16	0.8														▲
	SNMG120412	12.7	12.7	4.76	5.16	1.2														▲

中等切削
Moderate

产品库存 Product stock ▲ 主推牌号备库存 Main grade reserve stock ○ 按订单生产 Make-to-order

